



## LINGATEC SOLUÇÃO EM MOVIMENTAÇÃO DE CARGAS LTDA

Rua Buri, 149 - Laranjeiras – CAIEIRAS/SP – CEP: 07739-600

11-4441-5420 - vendas@lingatec.com.br - www.lingatec.com.br



### Green Pin® Pear Shaped Link EN 1677-4 GR8

#### Grade 8 pear shaped link EN 1677-4

- **Material:** alloy steel, grade 8, quenched and tempered
- **Safety factor:** MBL equals 4 x WLL
- **Standard:** EN 1677-4
- **Finish:** painted yellow (J), red (R) or white
- **Temperature range:** -40°C up to +200°C
- **Certification:** 2.1 2.2 3.1 MPI<sup>b</sup>



MP

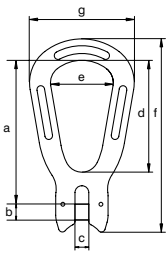

for chain diameter		working load limit	length	diameter pin		width	length inside	width inside	length	width outside	weight each
mm	inch			a mm	b mm						
5	<sup>3</sup> / <sub>16</sub>	0.8	85	6	7	64	33	109	55	0.14	
6	<sup>7</sup> / <sub>32</sub>	1.12	84	8	7	64	33	109	55	0.14	
7-8	<sup>1</sup> / <sub>4</sub> - <sup>5</sup> / <sub>16</sub>	2	101	9	9	77	40	132	69	0.34	
10	<sup>3</sup> / <sub>8</sub>	3.2	125	13	12	97	50	165	84	0.77	
13	<sup>1</sup> / <sub>2</sub>	5.4	161	16	15	125	66	213	110	1.62	
16	<sup>5</sup> / <sub>8</sub>	8.2	198	20	19	154	84	262	140	2.72	
18-20	<sup>3</sup> / <sub>4</sub>	12.8	253	24	23	198	104	331	166	4.28	