

**Green Pin® Connecting Link EN 1677-1 GR8**

**Grade 8 connecting link EN 1677-1**

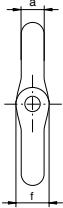

c  
MJ

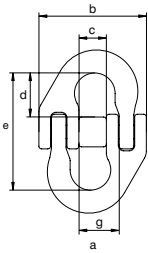

- **Material:** alloy steel, grade 8, quenched and tempered
- **Safety factor:** MBL equals 4 x WLL
- **Standard:** EN 1677-1
- **Finish:** painted yellow (J), red (R) or white
- **Temperature range:** -40°C up to +200°C
- **Certification:** 2.1 2.2 3.1 MPI<sup>®</sup> DGVU

for chain diameter		working load limit	diameter	width outside	width inside	length inside	length inside	diameter eye	width inside	weight each
mm	inch		a mm	b mm	c mm	d mm	e mm	f mm	g mm	kg
6	7/32	1.12	8	42	11	20	52	11	15	0.09
7-8	1/4 - 5/16	2	9	53	14	20	55	13	19	0.15
10	3/8	3.2	10	66	18	23	64	18	23	0.28
13	1/2	5.4	14	83	21	32	85	24	28	0.63
16	5/8	8.2	17	103	25	40	105	28	34	1.16
18-20	3/4	12.8	21	120	33	50	129	33	42	1.95
22	7/8	15.5	23	143	40	55	140	37	51	2.94
26	1	21.6	26	160	45	60	153	46	57	4.12
32	1 1/4	32.8	39	197	52	68	174	56	67	8.3