



## LINGATEC SOLUÇÃO EM MOVIMENTAÇÃO DE CARGAS LTDA

Rua Buri, 149 - Laranjeiras – CAIEIRAS/SP – CEP: 07739-600

11-4441-5420 - vendas@lingatec.com.br - www.lingatec.com.br

### Green Pin® Omega Link EN 1677-1 GR8

#### Grade 8 omega link EN 1677-1



CO

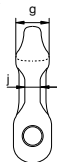
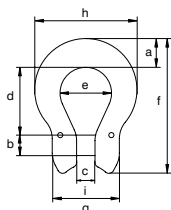

- **Material:** alloy steel, grade 8, quenched and tempered
- **Safety factor:** MBL equals 4 x WLL
- **Standard :** EN 1677-1
- **Finish:** painted yellow (J), red (R) or white
- **Temperature range:** -40°C up to +200°C
- **Certification:** 2.1 2.2 3.1 MPI<sup>b</sup> DGUV

for chain diameter		working load limit	width	diameter pin	width	length inside	width bow	length outside	thickness	width outside	width outside	thickness	weight each
mm	inch	t	a mm	b mm	c mm	d mm	e mm	f mm	g mm	h mm	i mm	j mm	kg
5	<sup>3</sup> / <sub>16</sub>	0.8	14	6	7	26	20	53	13	41	28	6	0.07
6	<sup>7</sup> / <sub>32</sub>	1.12	14	8	7	25	20	53	13	41	28	6	0.07
7-8	<sup>1</sup> / <sub>4</sub> - <sup>5</sup> / <sub>16</sub>	2	20	9	9	34	24	71	16	55	32	9	0.20
10	<sup>3</sup> / <sub>8</sub>	3.2	19	13	12	40	31	82	17	63	42	11	0.28
13	<sup>1</sup> / <sub>2</sub>	5.4	25	16	15	51	40	106	20	84	54	14	0.64
16	<sup>5</sup> / <sub>8</sub>	8.2	32	20	19	64	48	132	25	104	68	17	1.28
18-20	<sup>3</sup> / <sub>4</sub>	12.8	38	24	23	80	59	163	30	126	82	22	2.25